

# One Piece Adjustable Angle Footplate - AT5041

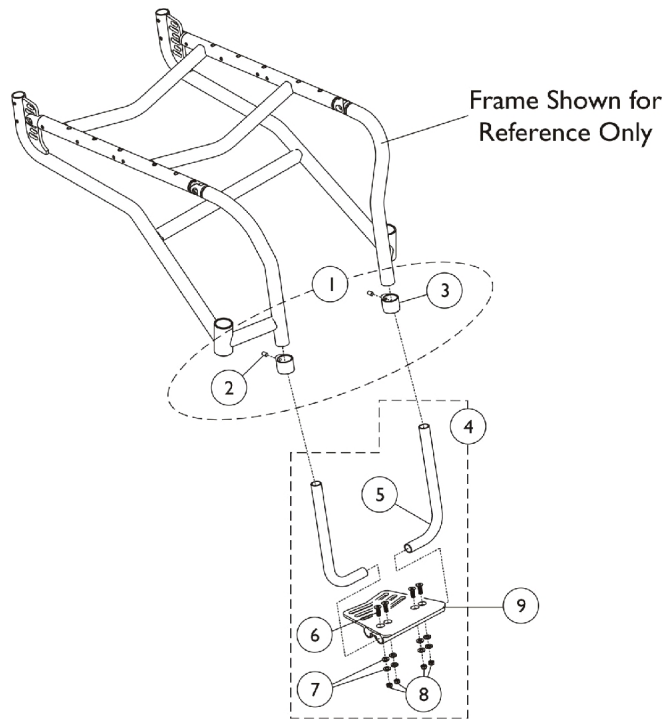

Item Number	Note	Part Number	Description	Quantity Per	
				Package	Assembly
1	A	1116379	Kit, Clamps Footrest	1	1
2			NLA - Screw, Socket Set Cone Point (1/4-20 x 1/2")	1	2
3			NLA - Clamp, Footrest	1	2
4	B,C	1046420-NLA	NLA - Hardware, Footplate Mounting	1	1
4	C,D	1114069-NLA	NLA - Hardware, Footplate Mounting	1	1
4	C,E	1058667-NLA	NLA - Hardware, Footplate Mounting	1	1
4	C,F	1114068-NLA	NLA - Hardware, Footplate Mounting	1	1
5	B	1046409-NLA	NLA - Tube, Support, Footplate, Black	1	2
5	D	1112174-NLA	NLA - Tube, Support, Footplate, Black	1	2
5	E	1056296-NLA	NLA - Support Tube, Footplate	1	2
5	F	1112177-NLA	NLA - Tube, Support, Footplate, Black	1	2
6		1046421-NLA	NLA - Screw, Socket Flat Head (1/4-28 x 1")	1	4
7		1013971	Washer, Nylon (1/4 x 7/16 x 5/64")	1	8
8		1065362	Locknut (1/4-28)	1	4
9		See Chart	#9 Adjustable Angle Footplates	1	1
NOTE: A - Includes items 2 and 3. B - Tapered Front - 14-20" Wide C - Includes items 5-8. D - Tapered Front - 21-22" Wide E - "V" Front - 12-20" Wide F - "V" Front - 21-22" Wide					

## #9 Adjustable Angle Footplates

Chair Width	Tapered Front Frame	"V" Front Frame
12-14"	1046461-NLA	1046461-NLA

# One Piece Adjustable Angle Footplate - AT5041

## #9 Adjustable Angle Footplates

Chair Width	Tapered Front Frame	"V" Front Frame
15"	1046462	1046462
16"	1046463-NLA	1046463-NLA
17"	1046464-NLA	1046464-NLA
18"	1046465-NLA	1046465-NLA
19"	1046466	1046465-NLA
20-22"	1046466	1046466